

Marine Fans

New range with accessories





■ **ENAG fans**

Our range of ENAG fans has been designed especially for the marine environment.
With more than 30 years' experience in fan design and manufacture, efficiency and reliability are assured.

■ **Advantages**

Designed to be reliable and rugged, ENAG fans are manufactured in accordance with the major marine classification authorities such as Bureau Veritas and DNV.

■ **Housing**

Axial type : steel, aluminum or stainless steel.

Robust construction :

- Max int. \varnothing : 1700mm (for larger please consult us)
- 8 mm flange (10 mm for external use)
- Epoxy coated or galvanised finish

■ **Impeller**

Made from either an aluminum hub and armoured polypropylene impeller blades or aluminum hub and blades

For a given diameter and with the right motor power we can obtain different combinations of Flow/Pressure

■ **Motor**

Dimensioned for long life in permanent service.

Efficiency upto 90%.

Double impregnation of the windings and tropicalisation.

AC Motors:IP 55 – power from 0.18kW to 37kW

DC Motors: IP 55 – power from 0.18kW to 3kW

New brushless technology – Reduced maintenance – Variable speed – High efficiency

■ **Certification**

Manufactured in accordance with classification authorities standards.

ATEX according to the zone imposed by current standards.

■ **Options**

We can supply different options according to customer requirements :

- Flow, pressure, housing diameter
- Short housings - Steel, aluminum or stainless steel
- AC fans : 50/60Hz, 230V to 690V three phase, 230V single phase
- DC fans : 12VDC, 24VDC, 48VDC, 72VDC, 110VDC
- Fans for specific applications eg. ATEX

Marine fans

Axial marine fan range

Integrated converter for 24VDC

Part number :

VA - 0.37KW 3000 RPM \varnothing 320 AC

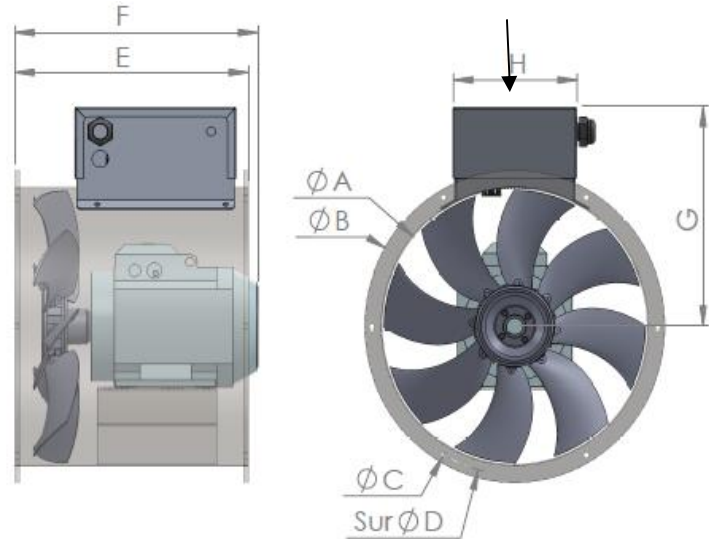
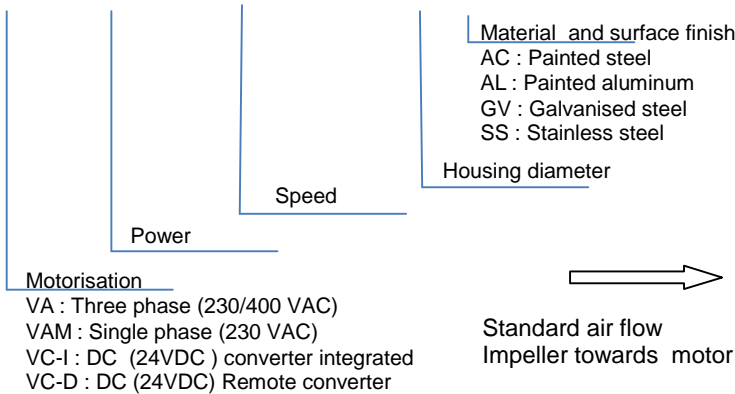

Int \varnothing 1700mm max (larger, please consult us)

VA : AC fan

VC : DC fan

3000RPM		Correspondance Previous type	Low limits		High limits		DIMENSIONS								
Housing Diameter	Power		Flow (m ³ /h)	Pressure st (mm.Wg)	Flow (m ³ /h)	Pressure st (mm.Wg)	A	B	C	D	E	F VA	F VC	G	H
\varnothing 165	0,13kW *	VA/VC 8-5	750 - 30	30	1000 - 5	5	165	200	6x \varnothing 7	185	See data sheet				
\varnothing 255	0,37kW **	VA/VC 12-15	800 - 25	25	1450 - 5	5	255	300	6x \varnothing 7	280	280	295	295	245	185
\varnothing 320	0,37kW *	VA/VC 30-16	2200 - 30	30	3800 - 6	6	320	370	6x \varnothing 9	350	280	295	295	290	185
	0,55kW *	VA/VC 40-14	3000 - 25	25	4600 - 7	7						295	340		
	0,75kW *	VA/VC 42-22	3300 - 34	34	5000 - 7	7						315	340		
\varnothing 355	0,37kW *	VA/VC 36-17	2500 - 26	26	4500 - 7	7	355	409	6x \varnothing 9	385	310	310	310	310	185
	0,55kW *	VA/VC 48-15	3000 - 30	30	5500 - 8	8						310	345		
	0,75kW *	VA/VC 55-15	3800 - 28	28	6200 - 8	8						320	345		
	1,1kW *	VA/VC 60-18	4200 - 40	40	6600 - 7	7						320	365		
	1,5kW *	VA/VC 65-27	5200 - 40	40	7900 - 8	8						385	365		
\varnothing 405	0,75kW *	VA/VC 60-15	3600 - 32	32	7000 - 7	7	405	459	6x \varnothing 9	435	320	330	355	335	185
	1,1kW *	VA/VC 72-16	4500 - 39	39	8300 - 9	9						330	375		
	1,5kW *	VA/VC 80-20	4200 - 50	50	9200 - 8	8						395	375		
	2,2kW	VA 90-30	6200 - 56	56	10600 - 9	9						395			
\varnothing 455	1,1kW *	VA/VC 70-25	4500 - 36	36	9500 - 8	8	455	515	6x \varnothing 9	490	400	400	400	365	215
	1,5kW *	VA/VC 80-33	6000 - 44	44	10700 - 9	9						400	400	365	215
	2,2kW *	VA/VC 100-22	6000 - 60	60	13000 - 9	9						400	450	365	215
	3kW	VA 110-30	6500 - 71	71	12300 - 9	9						420			
	4kW	VA 120-40	7000 - 79	79	14000 - 9	9						420			
\varnothing 505	1,5kW *	VA/VC 95-25	6700 - 38	38	12500 - 7	7	505	565	8x \varnothing 9	540	420	420	420	390	215
	2,2kW *	VA/VC 100-36	8000 - 46	46	13600 - 9	9						420	460	390	215
	3kW	VA/VC 130-30	8000 - 53	53	15500 - 9	9						430			
	4kW	VA 150-36	10000 - 71	71	17300 - 8	8						430			
\varnothing 555	1,5kW *	VA/VC 110-25	8000 - 40	40	15000 - 7	7	555	615	8x \varnothing 9	590	450	450	450	420	215
	2,2kW *	VA/VC 140-22	10000 - 38	38	16400 - 9	9						450	465	420	215
	3kW	VA 140-28	7800 - 56	56	16800 - 9	9						450			
	4kW	VA 150-45	8500 - 81	81	18600 - 9	9						470			
\varnothing 606	2,2kW *	VA/VC 120-30	7000 - 52	52	15500 - 8	8	606	680	8x \varnothing 9	645	470	470	475	445	215
	3kW	VA 140-40	7600 - 63	63	20000 - 8	8						470			
	4kW	VA 170-35	12000 - 55	55	22000 - 9	9						485			
	5,5kW	VA 200-40	14400 - 64	64	24800 - 7	7						485			

* Exists as both VC-I and VC-D (24V)

** Exists in version VC-D (24V)

Marine fans

Axial marine fan range

VA : AC fan
VC : DC fan

1500RPM		Correspondance Previous type	Low limits		High limits		DIMENSIONS								
Housing Diameter	Power		Flow (m ³ /h)	Pressure (mm.Wg)	Flow (m ³ /h)	Pressure (mm.Wg)	A	B	C	D	E	F VA	F VC	G	H
Ø355	0,37kW *	VA/VC 15-10	1500	- 10	2600	- 1	355	410	6xØ9	385	310	310		310	185
Ø405	0,37kW *	VA/VC 20-14	2800	- 12	4600	- 1	405	460	6xØ9	435	320	320		335	185
Ø455	0,37kW *	VA/VC 35-17	3500	- 17	6700	- 1	455	515	6xØ9	490	400	400	400	365	215
	0,55kW *	VA/VC 50-15	5000	- 17	6000	- 1						400	400	365	215
	0,75kW *	VA/VC 55-17	5500	- 17	9500	- 1						400	400	365	215
Ø505	0,75kW *	VA/VC 60-19	6000	- 19	10300	- 1	505	565	8xØ9	540	420	420	420	390	215
Ø555	0,75kW *	VA/VC 60-20	6000	- 20	10500	- 1	555	615	8xØ9	590	450	450	450		
	1,1kW *	VA/VC 80-19	8000	- 22	13100	- 1						450	450	420	215
	1,5kW *	VA/VC 100-20	7000	- 28	13300	- 1						450	450		
Ø606	1,5kW*	VA/VC 100-25	8500	- 25	16300	- 1	606	680	8xØ9	645	470	470	470	445	215
	2,2kW*	VA/VC 120-25	9000	- 31	15700	- 1						470	475	445	215
	3kW	VA 125-28	12200	- 31	18200	- 1						470			

* Exists as both VC-I and VC-D (24V)

1500RPM		Correspondance Previous type	Low limits		High limits		DIMENSIONS					
Housing Diameter	Power		Flow (m ³ /h)	Pressure (mm.Wg)	Flow (m ³ /h)	Pressure (mm.Wg)	A	B	C	D	E	F
Ø706	4kW	VA 125-45	12500	- 45	21000	- 8	706	782	12xØ12	745	470	470
Ø807	7,5kW	VA 200-55	20000	- 55	31000	- 11	807	895	12xØ12	850	550	570
Ø807	11kW	VA 300-45	30000	- 45	47000	- 8						750
Ø1010	11kW	VA 350-40	30000	- 71	55000	- 9	1010	1096	16xØ14	1060	650	750
Ø1010	15kW	VA 420-40	38000	- 69	64000	- 10						800

1000RPM		Correspondance Previous type	Low limits		High limits		DIMENSIONS					
Housing Diameter	Power		Flow (m ³ /h)	Pressure (mm.Wg)	Flow (m ³ /h)	Pressure (mm.Wg)	A	B	C	D	E	F
Ø1400	22kW	VA 500-50	48000	- 68	87000	- 9	1400	1532	20xØ18	1490	800	900
Ø1700	22kW	VA 900-39	60000	- 73	124000	- 8	1700	1832	28xØ24	1780	1000	1000
Ø1700	30kW	VA 1100-40	30000	- 71	150000	- 7						

Performance Axial Fans 3000 rpm

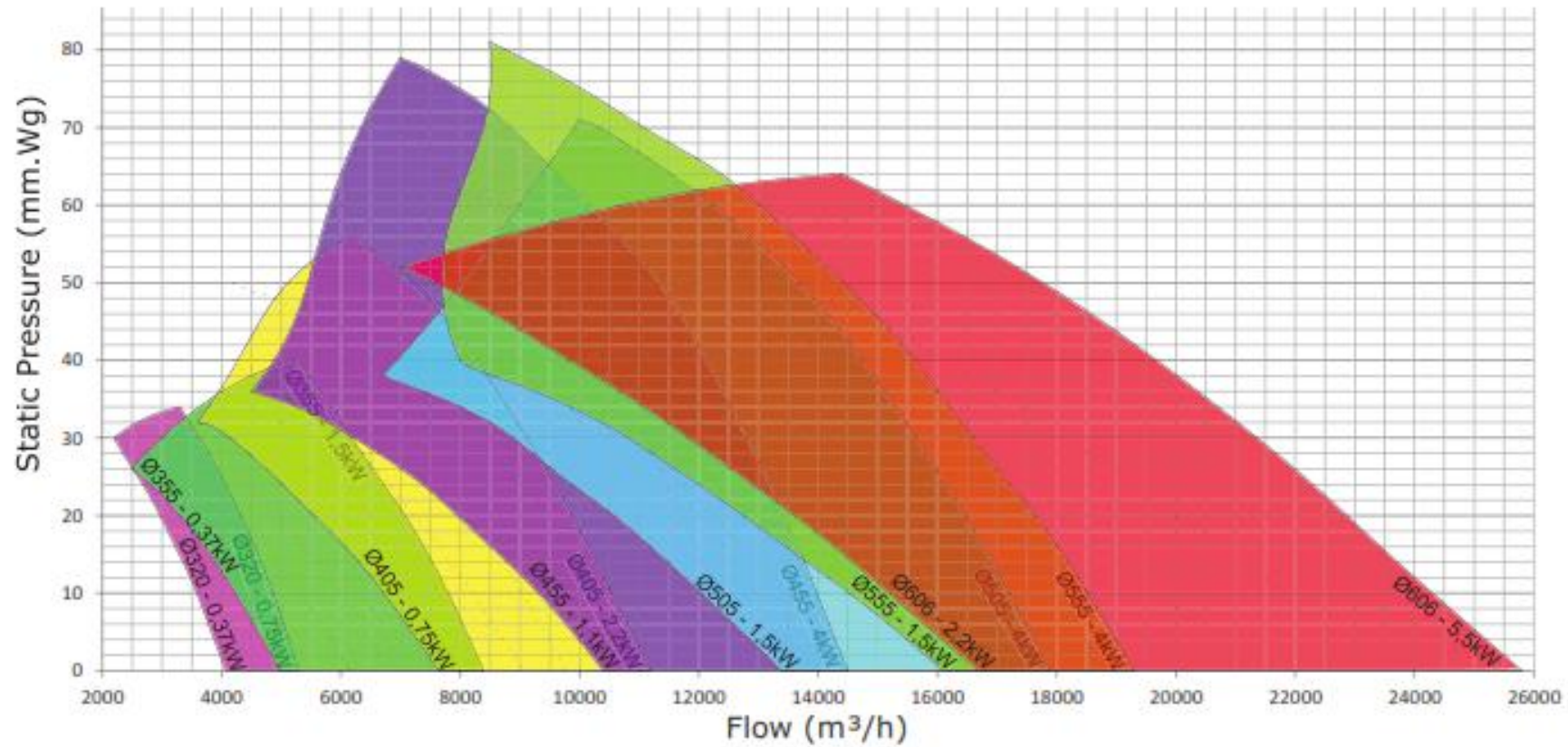

Performance Axial Fans 1500 rpm

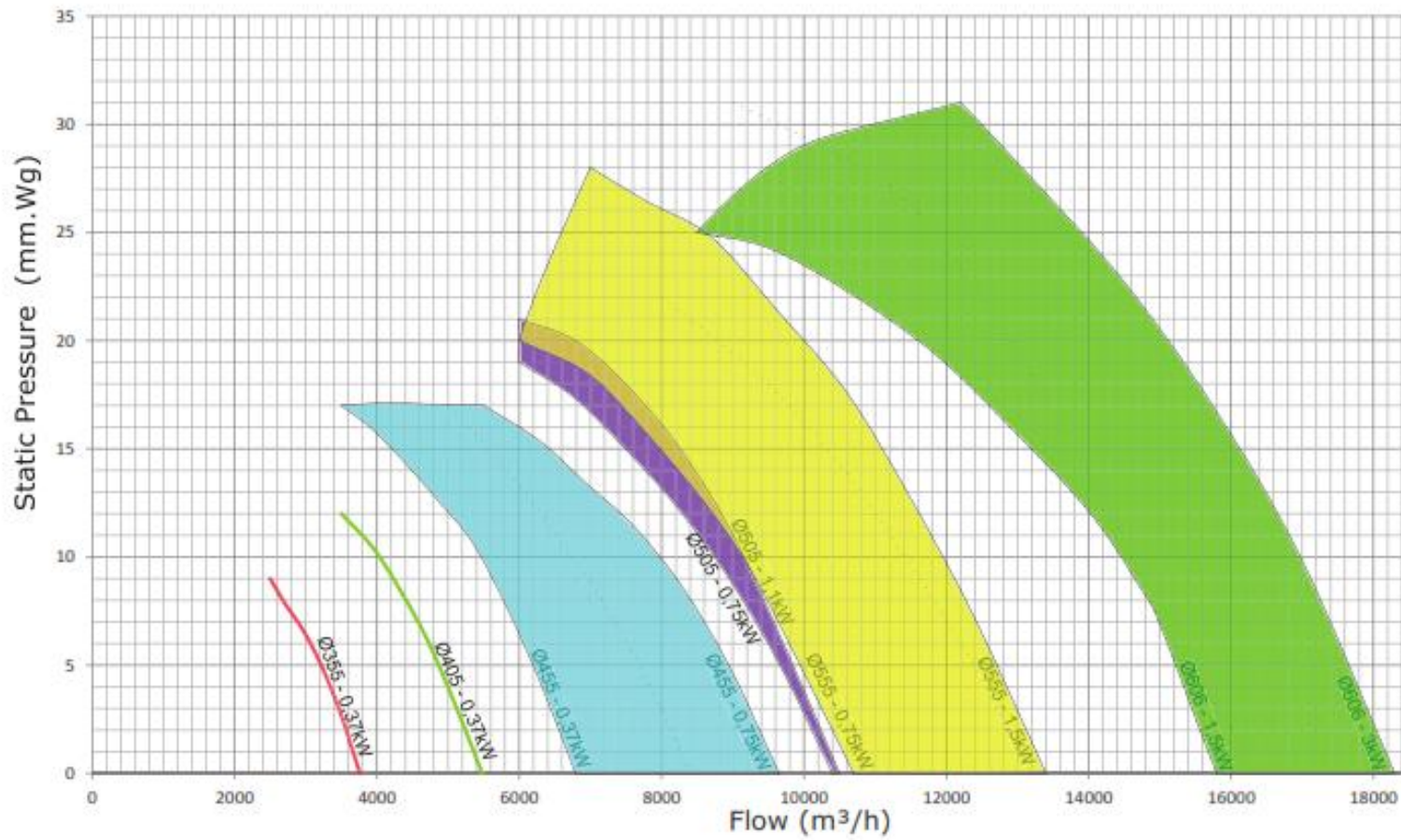

Accessories

We supply different options on request : Start up kit, variable speed, grids, fire dampers, flexible couplings, Shut off damper, mushroom vents, water separators ...

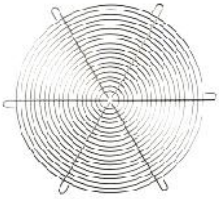

Grids

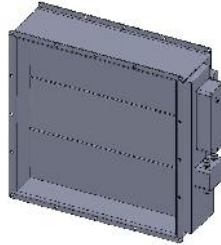

**Fire dampers,
Shut off dampers**

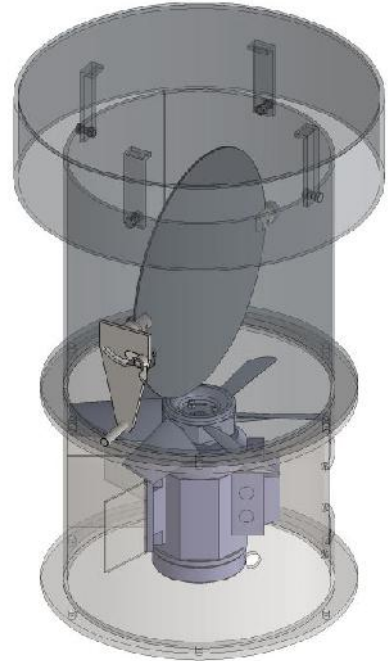

Assembly example

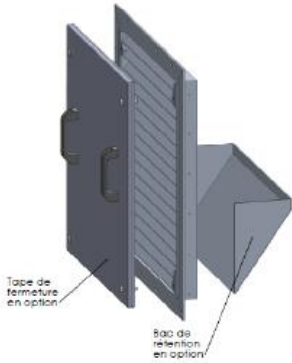

Louvres

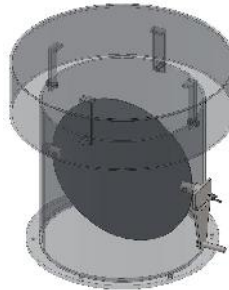

**Mushroom vent with shut
off damper**

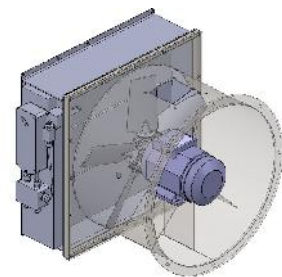

Assembly example

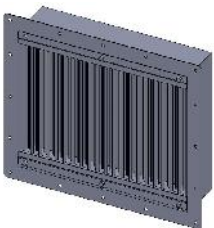

Water separator

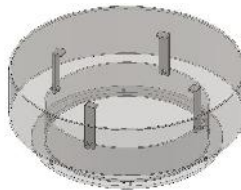

Mushroom vent

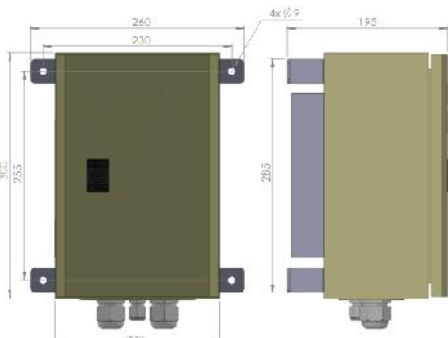

**Converter
cabinet**



**Flexible
coupling and
mounting pins**



**Supports or
mounting feet**

Centrifugal fans are ideally suited to ventilation of living quarters:

- Lower noise level than axial fans
- Higher static pressure

ENAG centrifugal fans are manufactured using the same low maintenance technology as the axial fan range ensuring robustness and reliability.

- Housing: Steel, aluminum or stainless steel.
- Impeller: Steel, aluminum or plastic.



AC Motors

Motors 1500 rpm – 230/400VAC 50Hz

Item	Type	Power (kW)	Current (A)	Flow (m3/h)	Static pressure (mmCE)
SEEM004561A	VAC 3 -26	0,18	0,62	300	26
SEEM005803	VAC 10 -55	1,1	2,4	1000	55
SEEM004571A	VAC 15 -36	0,75	1,8	1500	36
SEEM004570A	VAC 25 -47	1,1	2,4	2500	47

Motors 3000 rpm– 230/400VAC 50Hz

SEEM002292	VAC 2 -38	0,18	0,55	200	38
SEEM005104	VAC 11 -155	2,2	4,4	1100	155
SEEM005902	VAC 20 -158	2,2	4,4	2000	158
SEEM005160	VAC 78 -290	9,2	20,2	7800	290

DC Motors

Motors 1500 rpm- 24 VDC

SEEM002418	VCDC 6 -24	0,25	19	600	24
SEEM003835A	VCDC 10 -40	0,75	43	1000	40
SEEM020100	VCDC 28-40	1,1	65	2800	40

Motors 3000 rpm- 24 VDC

SEEM002146	VCDC 2 -38	0,25	19	200	38
SEEM003240	VCDC 3 -95	0,37	21	300	90
SEEM003614	VCDC 5 -85	1,1	65	500	85
SEEM020101	VCDC 12-100	1,5	82	1400	155